

Truss Systems

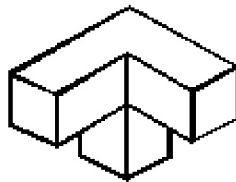
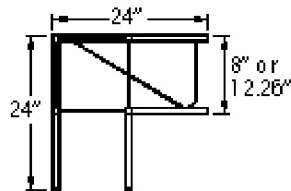
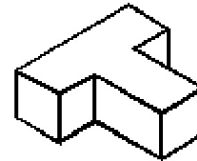
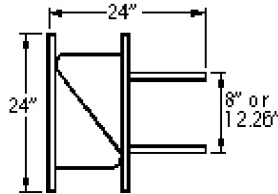
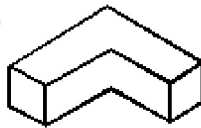
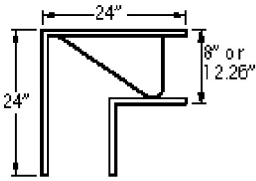
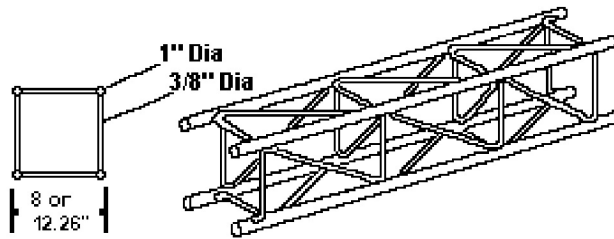

Banner Truss provides options of size, material and finish. The BA sizes (aluminum) are available with HILUSTER 1" diameter tubes which provide a finished look without the need of paint. As with the triangular truss, painted colors are available. BA/BS 8 and BA/BS 12.26 box trusses are available in 2 through 10 ft. sections or to your specifications.

1.6 lbs/ft = 8" Alum

3.4 lbs/ft = 8" Steel 1.8 lbs/ft = 12.26" Alum

3.7 lbs/ft = 12.26" Steel

DISPLAY

Trade Show

800-4-ANY-SIGN.com
"Call or Click"

Trade Show
Truss Systems 1

Industrial Design/ Engineering/ Marketing/ Signs/ Displays/ Exhibits/ Visual Solutions